

Agency: Commerce, Community and Economic Development**Grants to Municipalities (AS 37.05.315)****Grant Recipient: Willow****Federal Tax ID: 123456****Project Title:****Project Type: Remodel, Reconstruction and Upgrades**

Matanuska-Susitna Borough - Michelle Drive and Gina Circle Reconstruction

State Funding Requested: \$32,000**House District: Mat-Su Areawide (7-11)**

One-Time Need

Brief Project Description:

Construct, Extend and Upgrade Michelle Drive to Kenny Blvd. to Willow Fish Hook Road and Gina Circle to Kenny Blvd.

Funding Plan:

Total Project Cost:	\$400,000
Funding Already Secured:	(\$80,000)
FY2014 State Funding Request:	(\$32,000)
Project Deficit:	\$288,000

Funding Details:

FY 2012 funding by the Greater Willow Road Service Area Number 20 has provided \$ 75,000 for the In-House Design and Right - Of - Acquisition cost.

Detailed Project Description and Justification:

The exiting roads are Substandard due to poor sub-surface materials, Site Distance and Drainage is bad and realignment and extension of these roads, while providing a much safer and more direct access to the road system to support the newly constructed bridge across Willow Creek. This project will also be an economic benefit to the community, the Mat - Su Borough and the State Of Alaska to support present and future land and timber sales. This project is a good candidate for the Roads To Resources Program. This project is to upgrade Michelle Drive from the new bridge and continue straight out to Willow Fish / Hook Road, for a shorter and more direct route. Up-Grade Michelle Drive from north end of bridge to Gina Circle, then Gina Circle and extend it to Kenny Blvd.

Project Timeline:

The project should be completed by the end calendar year 2014 if it is funded this year.

Entity Responsible for the Ongoing Operation and Maintenance of this Project:

The Mat - Su Borough's Greater Willow Road Service Area #20

Grant Recipient Contact Information:

Name:	Mike Lachelt
Title:	Road Superintendent
Address:	350 east Dahlia Ave. Palmer, Alaska 99645
Phone Number:	(907)745-9823
Email:	

Has this project been through a public review process at the local level and is it a community priority? Yes No

<i>For use by Co-chair Staff Only:</i>
2:01 PM 5/9/2013

SOUTH DENALI DEVELOPMENT OPTIONS

	INCREMENTAL FUNDING SCENARIO 1	INCREMENTAL FUNDING SCENARIO 2	INCREMENTAL FUNDING SCENARIO 3
FY09 - FY13¹ State Funding (Secured)	<p>Funding: <u>\$13.4M</u></p> <ul style="list-style-type: none"> • Design and construct Phase I <ul style="list-style-type: none"> ○ 2.3-Mile gravel access road ○ 35-Campsite campground ○ 22-Stall day-use/trailhead parking ○ 0.6-Mile gravel trail ○ Maintenance shop • Preliminary design of access road to visitor center, transportation facility, and visitor center • MEA Electrical Extension 	<p>Funding: <u>\$13.4M</u></p> <ul style="list-style-type: none"> • Design and construct Phase I <ul style="list-style-type: none"> ○ 2.3-Mile gravel access road ○ 35-Campsite campground ○ 22-Stall day-use/trailhead parking ○ 0.6-Mile gravel trail ○ Maintenance shop • Preliminary design of access road to visitor center, transportation facility, and visitor center • MEA Electrical Extension 	<p>Funding: <u>\$13.4M</u></p> <ul style="list-style-type: none"> • Design and construct Phase I <ul style="list-style-type: none"> ○ 2.3-Mile gravel access road ○ 35-Campsite campground ○ 22-Stall day-use/trailhead parking ○ 0.6-Mile gravel trail ○ Maintenance shop • Preliminary design of access road to visitor center, transportation facility, and visitor center • MEA Electrical Extension
FY14 State Funding	<p>Funding: <u>\$3.0M</u></p> <ul style="list-style-type: none"> • Design and construct a 15-campsite walk-in campground • Design and construct up to an additional 5 miles of gravel trails 	<p>Funding: <u>\$5.0M</u></p> <ul style="list-style-type: none"> • Design and construct a 15-campsite walk-in campground • Design and construct up to an additional 5 miles of gravel trails • Design and construct ranger office addition to maintenance shop 	<p>Funding: <u>\$7.0M</u></p> <ul style="list-style-type: none"> • Design and construct a 15-campsite walk-in campground • Design and construct up to an additional 5 miles of gravel trails • Design and construct ranger office addition to maintenance shop • Design access road to visitor center, transportation facility, and visitor center
Future Funding Need	<ul style="list-style-type: none"> • \$28.65M 	<ul style="list-style-type: none"> • \$26.65M 	<ul style="list-style-type: none"> • \$24.65M

- Total project cost estimate is approximately \$46.0M (June 6, 2012 Engineer's Estimate), including MEA electrical extension work.

¹ FY09 \$8.9M (General Funds) - Access Road and Transportation Hub Building
 FY12 \$3.0M (General Funds) - Design
 FY13 \$1.5M (General Funds) - MEA Electrical Extension

OTHER PROJECT RELATED FUNDS IN-HAND

FFY12 \$0.95M (Scenic Byway Funds) – Transportation Hub Building Construction

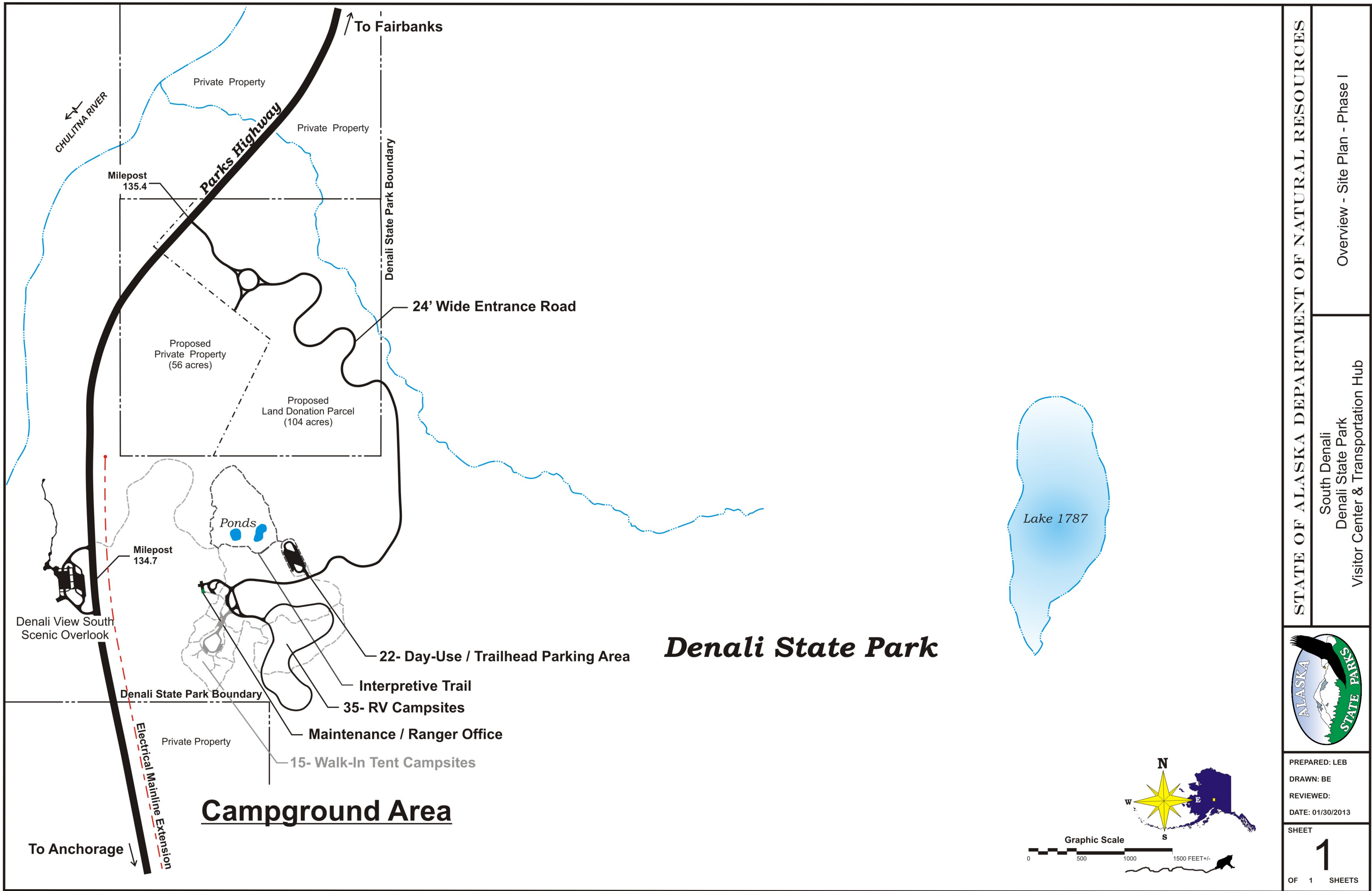

Denali State Park

Campground Area

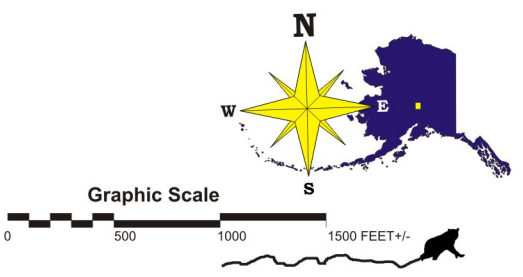
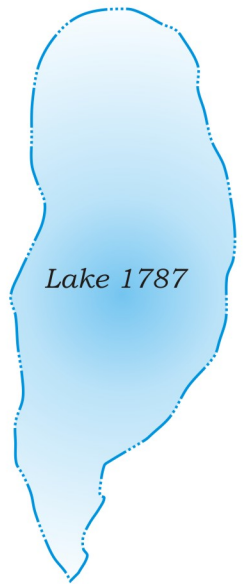

PREPARED: LEB
 DRAWN: BE
 REVIEWED:
 DATE: 01/30/2013

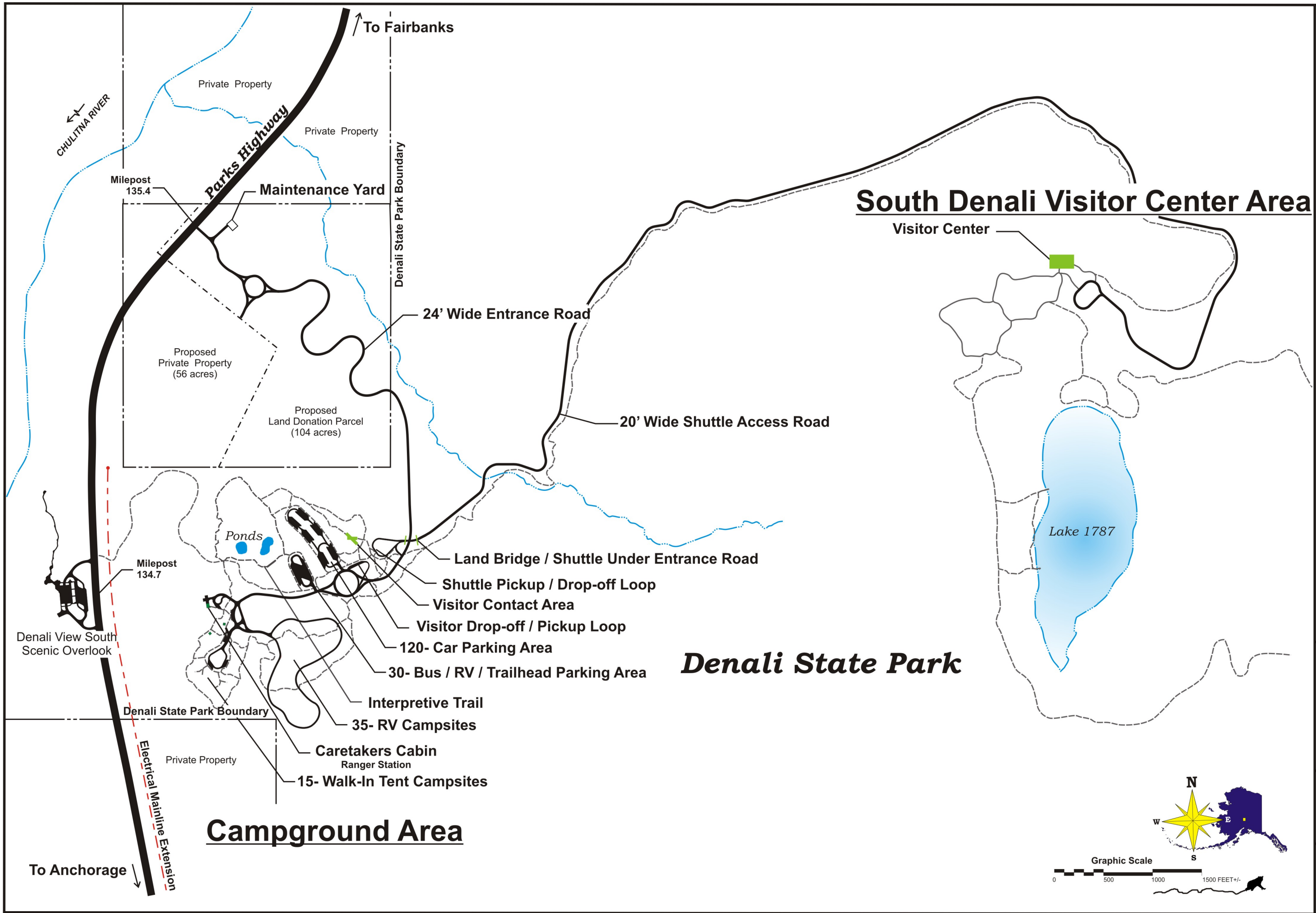

South Denali Visitor Center Area

Campground Area

STATE OF ALASKA DEPARTMENT OF NATURAL RESOURCES

Overview - Site Plan - Master Plan

South Denali
Denali State Park
Visitor Center & Transportation Hub



PREPARED: LEB
DRAWN: BE
REVIEWED:
DATE: 01/30/2013

SHEET
1
OF 1 SHEETS

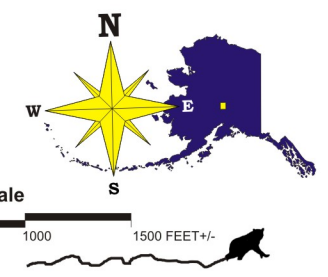

Denali State Park

Visitor Center

Lake 1787

Milepost 135.4

Milepost 134.7

Private Property

Private Property

Proposed Private Property (56 acres)

Proposed Land Donation Parcel (104 acres)

Ponds

Denali View South Scenic Overlook

Denali State Park Boundary

Private Property

Electrical Mainline Extension

To Anchorage

To Fairbanks

Maintenance Yard

Denali State Park Boundary

24' Wide Entrance Road

20' Wide Shuttle Access Road

Land Bridge / Shuttle Under Entrance Road

Shuttle Pickup / Drop-off Loop

Visitor Contact Area

Visitor Drop-off / Pickup Loop

120- Car Parking Area

30- Bus / RV / Trailhead Parking Area

Interpretive Trail

35- RV Campsites

Caretakers Cabin
Ranger Station

15- Walk-In Tent Campsites