

Agency: University of Alaska**Project Title:****Project Type:** New Construction and Land Acquisition

Mat-Su Campus - Valley Center for Art & Learning

State Funding Requested: \$23,500,000
One-Time Need**House District:** Mat-Su Areawide (13-16)**Brief Project Description:**

Design, planning and construction of University of Alaska and Mat-Su Borough's joint Art and Learning Center, Phase I.

Funding Plan:**Total Cost of Project:** \$23,500,000
*There is no other funding needed***Detailed Project Description and Justification:**

The Mat-Su Borough is the fastest growing area of the state, with a population that is expected to exceed 80,000 in the near term. UAA's Mat Su Campus is responding to this population growth with a plan to establish an educational and cultural hub that provides four-year academic programs.

The new 80,000-square-foot facility supports this vision and the maturing community by creating a state-of-the-art University library that is consistent with four-year institution needs; augmenting instructional space, laboratories, and faculty offices; providing sophisticated performance venues not currently available in the region; supporting UAA drama and music programs with teaching, rehearsal, and performance spaces; and establishing a borough branch library in the fast-growing Trunk Road area that would allow for centralized material distribution and operations.

Phase I of this effort would design and construct the following:

Center for Art and Learning (\$20M)

- 23,000 gsf
- 500 – 1000 seat auditorium
- Common area

Paramedic/Nursing Lab Addition (\$3.5 M):

- 10,000 gfs
- Three large classrooms with movable walls
- Labs for nursing and paramedic classrooms
- Flexible larger-scale lecture space
- Faculty offices that adjoin teaching labs
- Workspace and storage for program equipment
- Full-scale ambulance simulation lab

Project Timeline:

Upon receipt of the funding, the project timeline would consist of a six-month design phase and a two-year construction phase. The facility is expected to be ready for occupancy by mid-2013.

Entity Responsible for the Ongoing Operation and Maintenance of this Project:

University of Alaska

Grant Recipient Contact Information:

Name: Dennis Clark
Address: P.O. Box 2889
Palmer, AK 99745
Phone Number: 745-9726
Email: Dennis.Clark@matsu.alaska.edu

Has this project been through a public review process at the local level and is it a community priority? Yes No



Valley Center for Art & Learning

In concert with the development of a new vision for UAA's Mat Su College a conceptual design has been completed for a dynamic new facility housing libraries, performing arts and instructional space.

The new facility will be located at the east end of the existing campus situated between the Machentanz and Snodgrass buildings. Working in cooperation with ADOT a new drive is planned connecting the east end of the campus to the realigned Trunk Road.

The Mat Su Borough is the fastest growing area of the State with a population that is expected to exceed 80,000 in the near term. UAA's Mat Su Campus is responding with a plan to provide 4-year programs with an expected doubling of the student population within the next 10 years. The new Valley Center for Art and Learning supports this maturing community by:

- Creating a state-of-the art University library consistent with 4-year institution needs.
- Providing sophisticated performance venues not currently available in the region.
- Adding a Borough branch library in the fast growing Medical/Trunk Road area
- Centralizing distribution of Borough library materials reducing operational costs
- Supporting UAA drama and music programs with teaching, rehearsal and performance spaces



Concept Entry



Site Plan

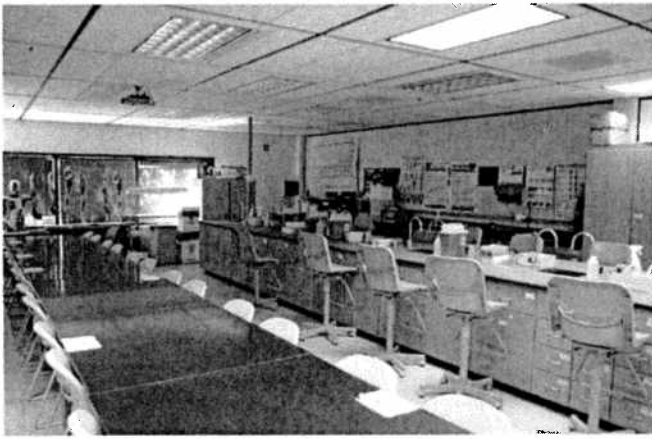

4. Facility Needs

This chapter describes major projects requiring capital funds that are in the current request reports. Following the Capital Requests List are additional projects identified during the planning process. The cost impact of these projects vary and they should be re-evaluated as to their validity and priority as this plan is updated and future Capital Requests are prepared.

Fiscal Year '08 - 13 Capital Requests

Mat-Su College Joint Library/Auditorium

Partners: Mat-Su College, Matanuska Susitna Borough, Valley Center for Art and Learning, State of Alaska

Budget request type: New construction

MAU ranking by the Provost or Vice Chancellor: 1 of 3

Project Abstract

The Matanuska-Susitna Borough has proposed a dual use facility consisting of a library and 1000-1500 seat auditorium. The initial conception of this building is a two wing building with each wing being a library. One wing would be the college library with the other serving as a central borough library. This design enables each library to function and be staffed separately since each has different metrics to measure success. There would be a common area between the two library wings. This common area would also serve as a lobby area for the auditorium. The borough has at present been focused on raising funds for such a facility currently targeting \$30 million as a number and sees a potential for use of college

land due to its central location for the core area of the borough, or at least locating this facility on Trunk Road.

This type of facility is very much in concert with the chancellor's idea of the Mat-Su Campus becoming a "public square" for the region. Cooperation on this level would enable this college to provide more summer programs for the community and expand its theatre, art and music curricula. This could be accomplished within the current cooperative agreement with the Valley Performing Arts Association. The new facility would help fulfill the goal of better integrating the campus with the community. It would bring more people to campus for a variety of events held in the auditorium and provide space for intellectual and cultural events for which no venue currently exists in the Mat-Su Valley.

Project Description

The preliminary concept plan is to construct a 75,000 to 80,000 gsf facility housing three main program elements – a college library, a community library/distribution center, and a 500-seat auditorium/theater. The college library is initially scoped at 33,000 gsf and includes consolidation of the library collection and related programs, classrooms, meeting spaces, and display areas.

The auditorium/theater will serve the needs of the college and community to host speakers, large lectures, and performing arts events. The Borough community library/distribution facility will feature a small community library and consolidate material distribution and collection repair services for the Borough library and school systems.

This project impacts Mat-Su students, library programs, course delivery, faculty, staff and the public. A preliminary conceptual plan has been developed jointly by UAA/MSC and the Matanuska-Susitna Borough. It is consistent with the UA Strategic plan by addressing the goals of student success, educational quality, faculty and staff strength, responsiveness to state needs, technology and facility development, and diverse sources of revenue (borough funding and user fees for auditorium space). The facility has been the top priority in the campus' strategic plan that has served as input to this master plan.

This project is also a stated priority in the Borough strategic plan. This project is driven by the strong likelihood of partnership with the Mat-Su Borough. UAA has conducted a space utilization analysis of the current Mat-Su library and classroom space and has determined that expansion is needed in these areas to address enrollment and population growth projections for the Mat-Su Valley.

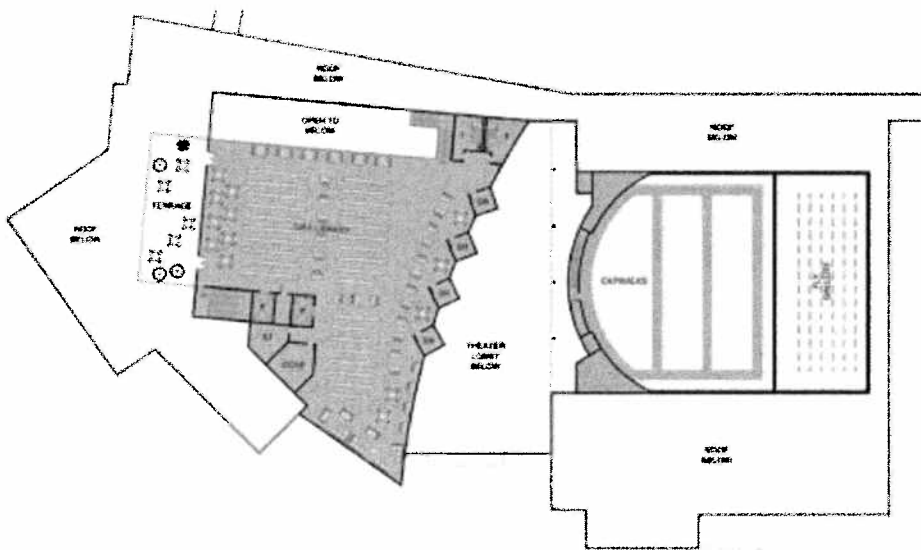

Floor Plan - Level 3

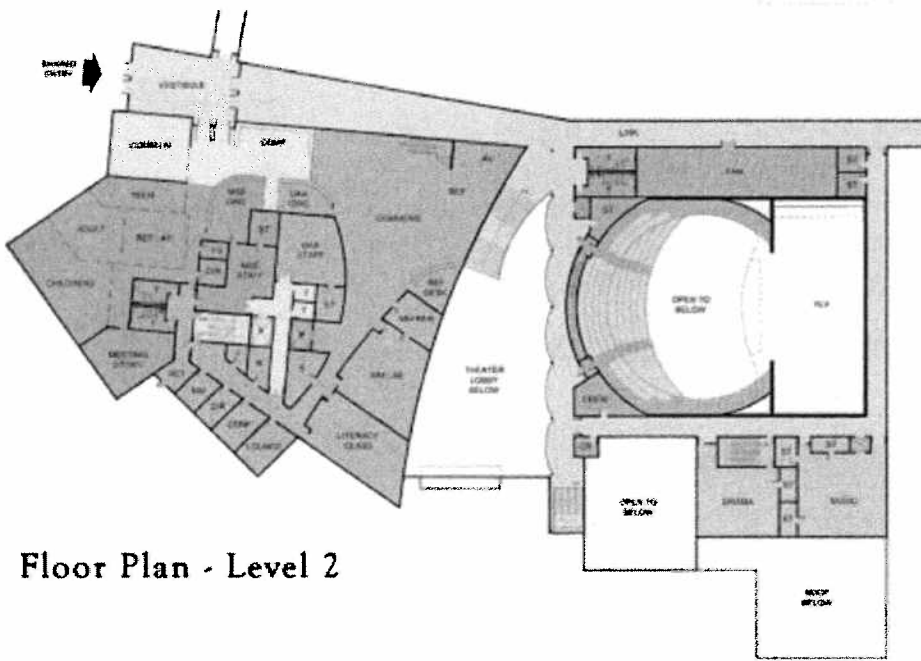

Floor Plan - Level 2

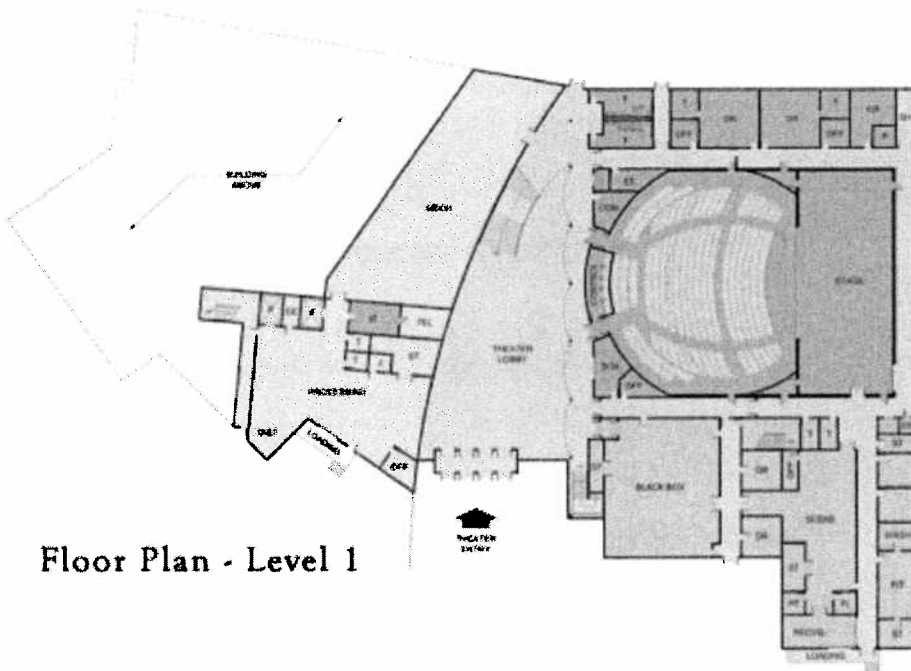

Floor Plan - Level 1

Anticipated Schedule

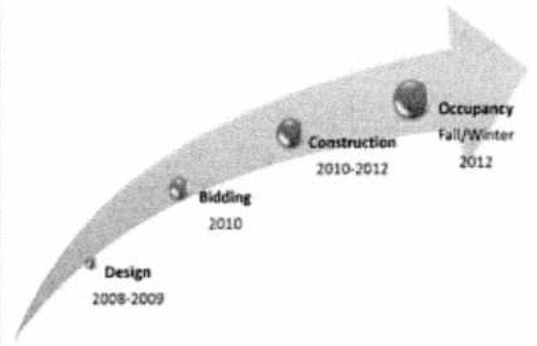

UAA and the Mat Su Borough have formed a unique association to plan, fund and operate this exciting facility. This collaboration allows multiple community needs to be served in one facility, reducing construction and long term operating costs. It also expands the constituent base and funding options that may include a combination of capital requests, bond sales, private funds and federal grants.

LEVEL 1 FLOOR PLAN

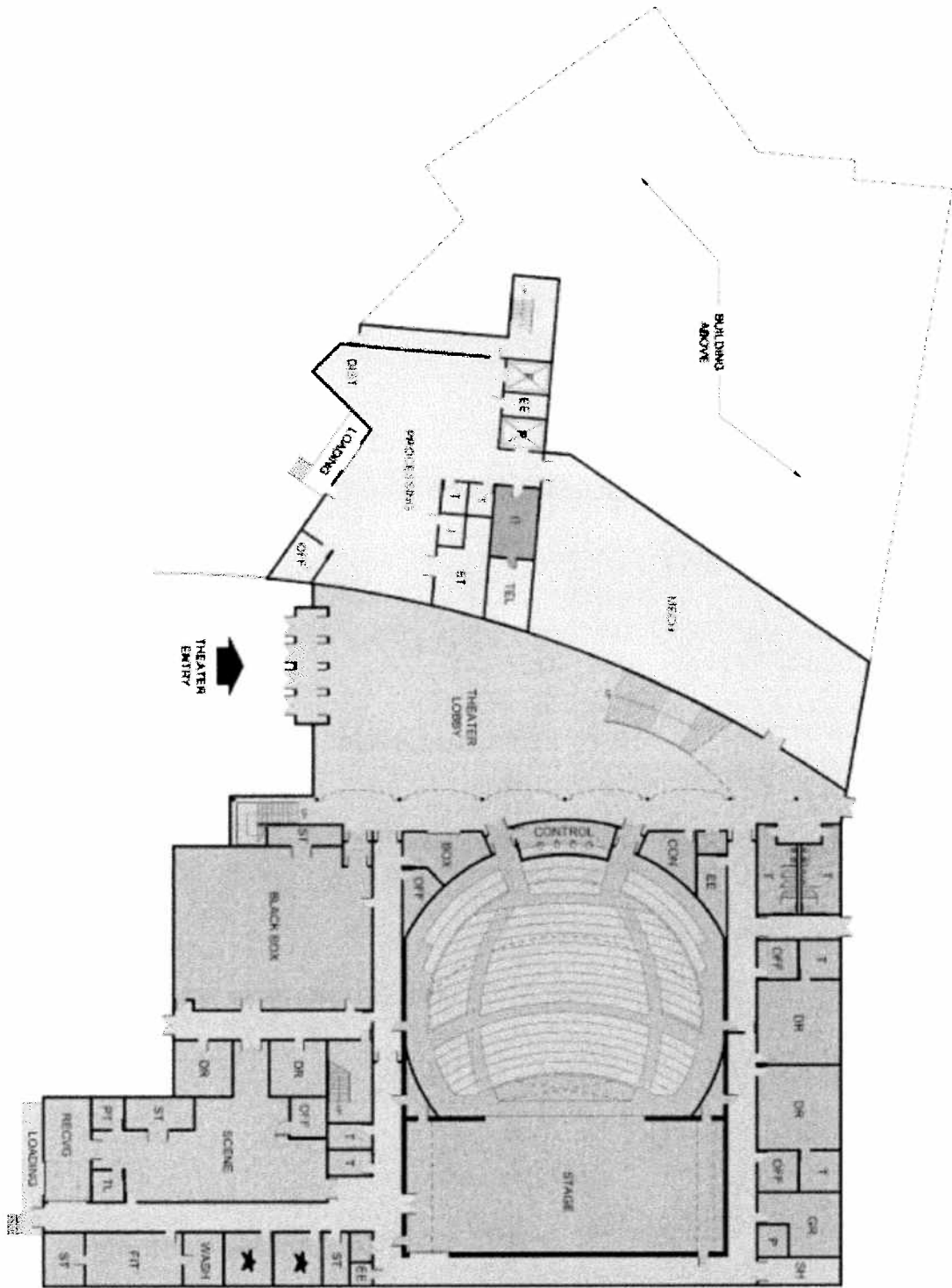

MAT-SU COLLEGE

VALLEY CENTER FOR ART & LEARNING



M. COOL CARLSON GREEN

JANUARY 2011

LEVEL 2 FLOOR PLAN

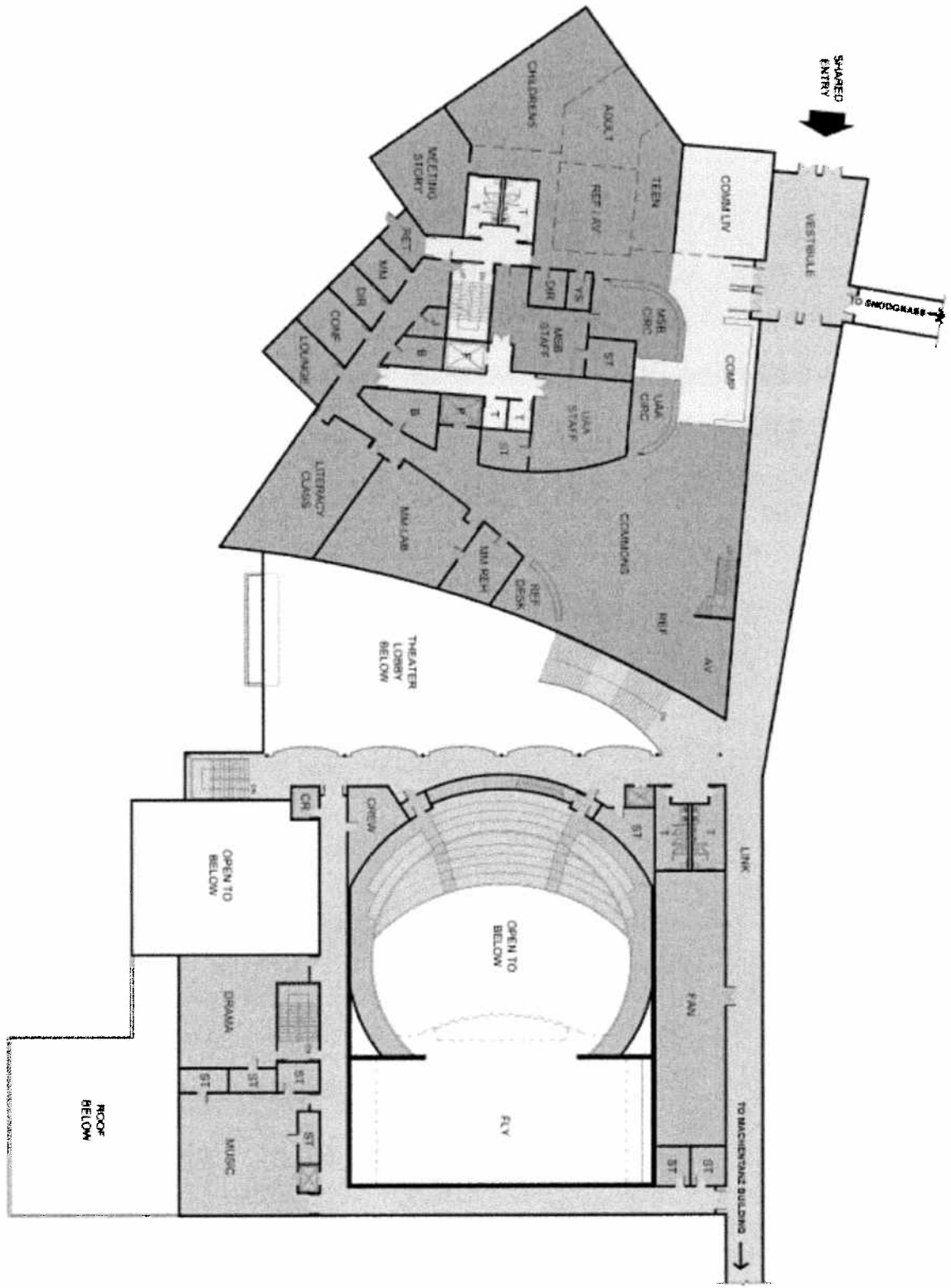

VALLEY CENTER FOR ART & LEARNING

January 25, 2008



LEVEL 3 FLOOR PLAN

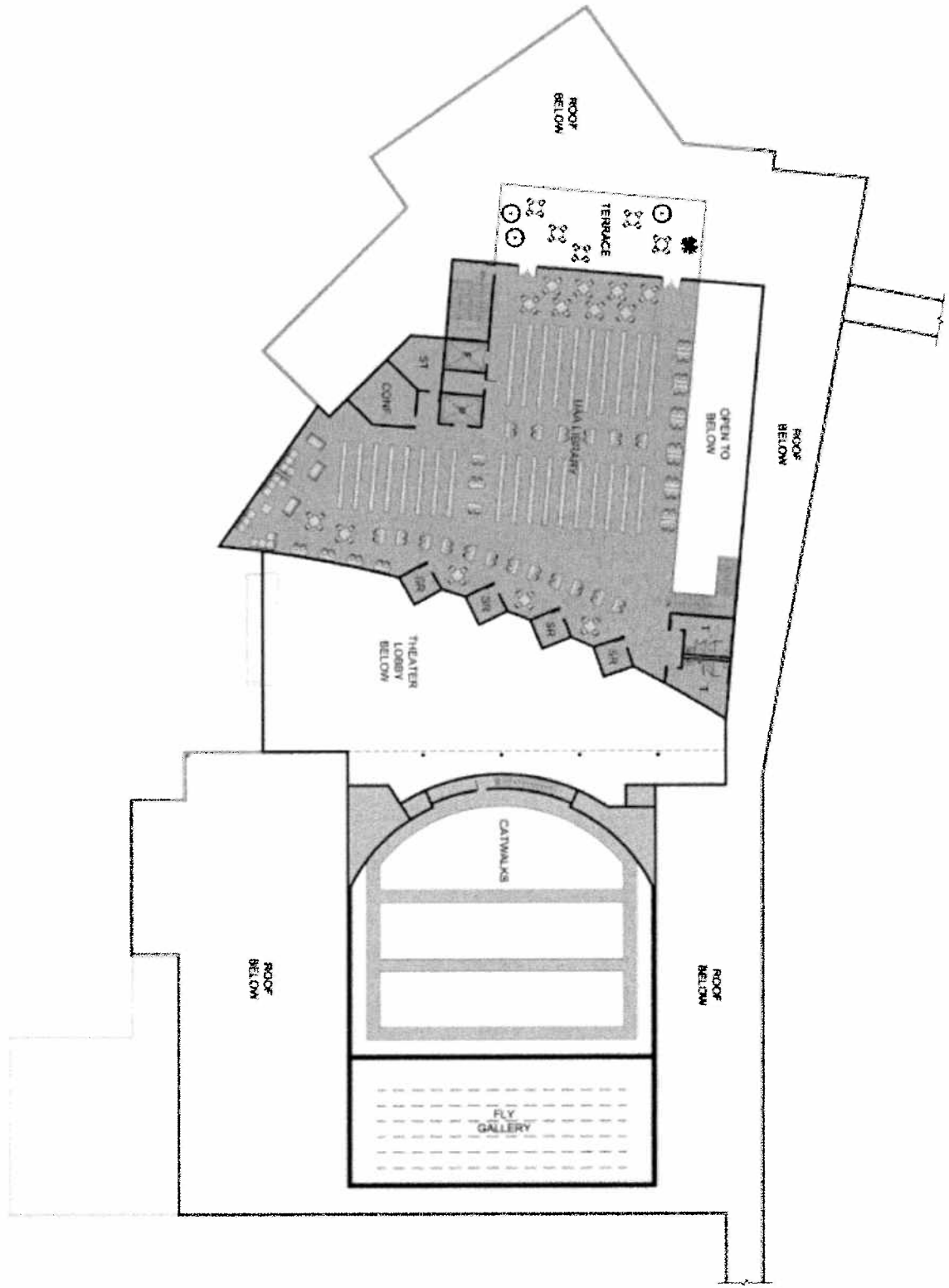

MAT-SU COLLEGE

VALLEY CENTER FOR ART & LEARNING



McCOOL CARLSON ORFEN

JANUARY 28, 2004

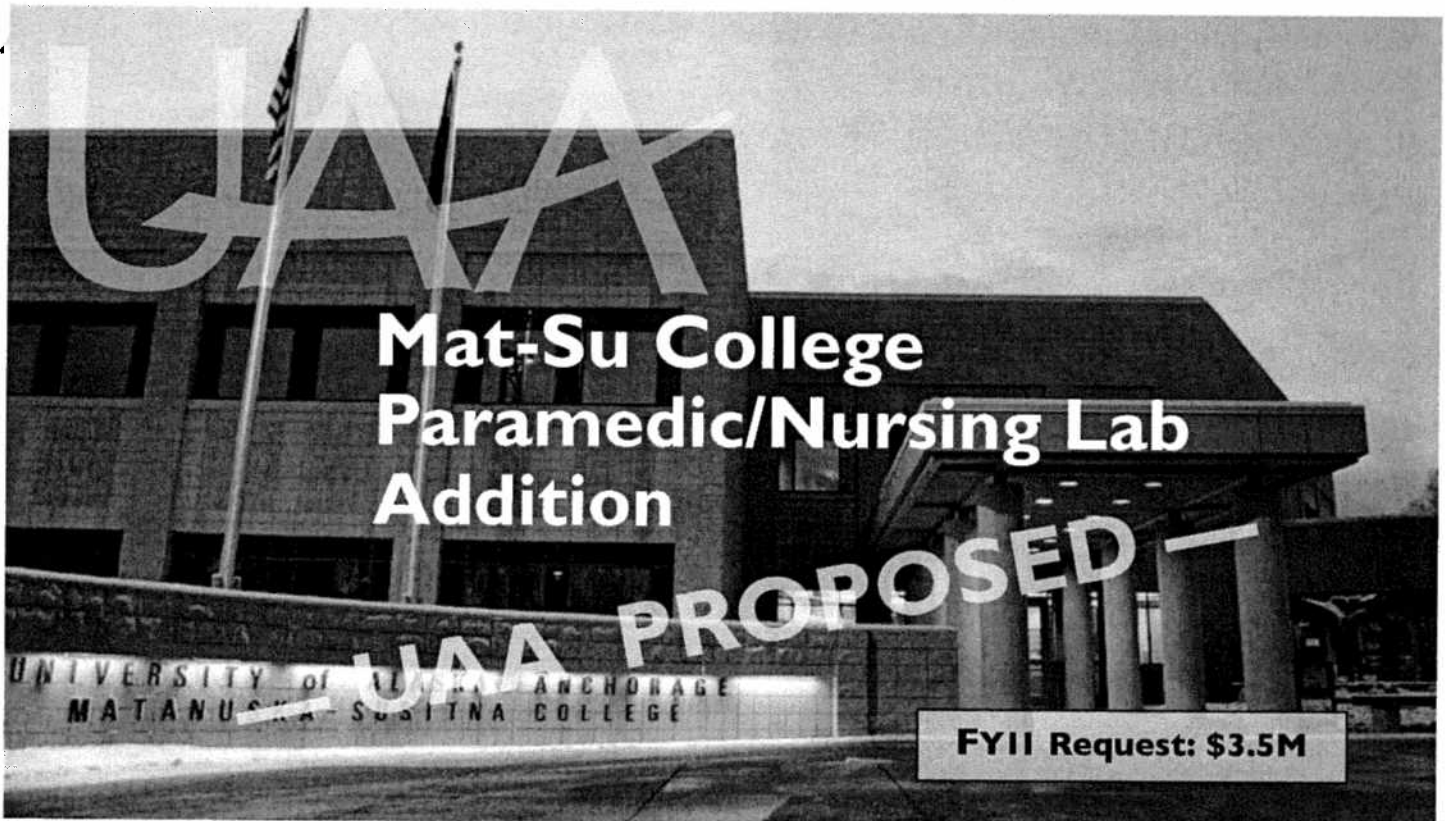

Mat-Su College (MSC) has been growing at a steady rate over the past several years, and enrollment has grown by nearly 20 percent in the last year. Currently, MSC's classroom space is scheduled to capacity. In order to meet student and state demand for our health care industry programs, we must expand our lab and classroom space. This proposed addition will provide for MSC's current need and near-future demand.

Current program facility need

MSC has offered a nursing program for several years. In fall of 2009, MSC launched its paramedic technology program (PTP); we are already at program capacity and have a waiting list for admission to the 2010 PTP. Currently, MSC's largest space seats only approximately 80 people. In order to adequately accommodate for both high-demand programs, MSC's requested addition will include three classrooms with movable walls that can serve as both a large lecture hall (up to 200 people) and smaller instructional space.

Proposed addition

The proposed project calls for approximately 10,000 gross square feet (gsf) of space to house classrooms, laboratories and faculty offices. This addition will effectively utilize the existing infrastructure (i.e. heating, air handling, common space, etc.); this will allow for construction cost savings.

The Addition specifics will include:

- three large classrooms with movable walls;
- labs for both the nursing and paramedic programs;
- flexible larger-scale lecture space;
- faculty offices that adjoin the teaching labs;
- workspace and storage for program equipment; and
- full-scale ambulance simulation lab for paramedic student drills.

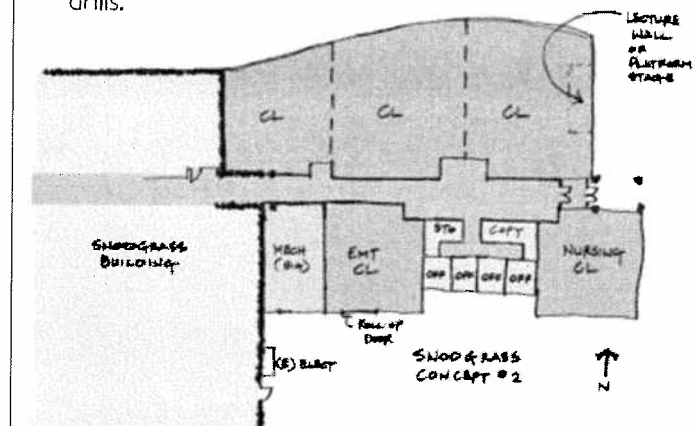

UAA Proposed Capital Project

Classroom and Paramedic/Nursing Lab Addition for Mat-Su College

Summary of Request

Mat-Su College has been growing at a steady rate over the past few years and it has become apparent that we will outgrow our existing space soon. It was not until this semester (fall 09) that we started to feel those growth pains. Our enrollment grew by nearly 20% this semester, filling morning, Friday and Saturday classroom space. We had begun the expansion planning process a couple of years ago, but did not anticipate that the need would come so soon. During the planning phase we began calling our project the Snodgrass Classroom Addition. This plan calls for approximately 10,000 square feet of classrooms, laboratories, faculty offices and work space. We decided on an addition to more effectively utilize the existing infrastructure (i.e. heating, air handling, common space, etc.). The vision is for three large classrooms with movable walls that can be pushed back to provide a large meeting space for up to two hundred people. Currently our largest space will accommodate approximately 80 people.

For several years we have offered a nursing program through UAA. The space is very small, therefore, the number of students is also very small. This fall we also started the Paramedic Technology Program. It was anticipated that we would start off slowly and build to a full complement of 16 students within a couple of years. We were surprised to have 16 students in the first year with a waiting list for 2010. It is possible that we may have to double the number of slots for fall 2010. With this in mind, the requested space includes labs for each of these programs in addition to the lecture rooms. We do not anticipate allowing these programs to grow too large as the number of graduates could out strip the community's need. The requested space will provide for the current and near future need.

In programs such as this we have found that the instructors need to be close at hand. In the planning we have made provisions for their offices to adjoin the labs. There will also be additional workspace and storage for the large amount of equipment needed for each of the programs. Additionally, the Paramedic Lab will need to include a full scale mock-up of an ambulance for student drills. If we are going to turn out students that are well trained and ready to work we must provide the most realistic training possible.

FY11 funding request: \$3.5M