

Agency: Commerce, Community and Economic Development**Grants to Municipalities (AS 37.05.315)****Grant Recipient: Petersburg****Federal Tax ID: 92-6000142****Project Title:****Project Type: Remodel, Reconstruction and Upgrades**

Petersburg - Crane Dock Improvements

State Funding Requested: \$500,000**House District: 2 / A**

Future Funding May Be Requested

Brief Project Description:

Project will construct additional dock and upland improvements at the crane dock in Petersburg.

Funding Plan:

Total Project Cost:	\$500,000
Funding Already Secured:	(\$0)
FY2012 State Funding Request:	<u>(\$500,000)</u>
Project Deficit:	\$0

Detailed Project Description and Justification:

Project will construct additional dock and upland improvements at the crane dock in Petersburg.

Petersburg is homeport to one of Alaska's most productive commercial fishing fleets and increasingly becoming a popular destination among cruiseship and recreational marine vessels. The infrastructure necessary to support these vessels is severely limited. Currently there is one public crane dock that provides service to the entire Petersburg commercial fishing fleet. The public dock approach is too narrow to allow large vehicles, or vehicles with utility trailers to back onto and turn into position for crane operation to load and unload equipment aboard marine vessels. The approach ramp for this highly used area also is used as access to and from the South Harbor, our largest community owned harbor, further adding to the dock approach congestion.

This project will widen the deck to allow vehicles to turn and trade positions with newly arriving vehicles. This will speed up the loading of commercial vessels and improve safety for users and pedestrians in South Harbor.

Project Timeline:

FY12-FY14

Entity Responsible for the Ongoing Operation and Maintenance of this Project:

City of Petersburg

Grant Recipient Contact Information:

Name:	Scott Hahn
Title:	City Manager
Address:	12 South Nordic Dr. Petersburg, Alaska 99833
Phone Number:	(907)772-4425
Email:	scott.hahn@ci.petersburg.ak.us

Has this project been through a public review process at the local level and is it a community priority? Yes No

<i>For use by Co-chair Staff Only:</i>
10:27 AM 5/27/2011

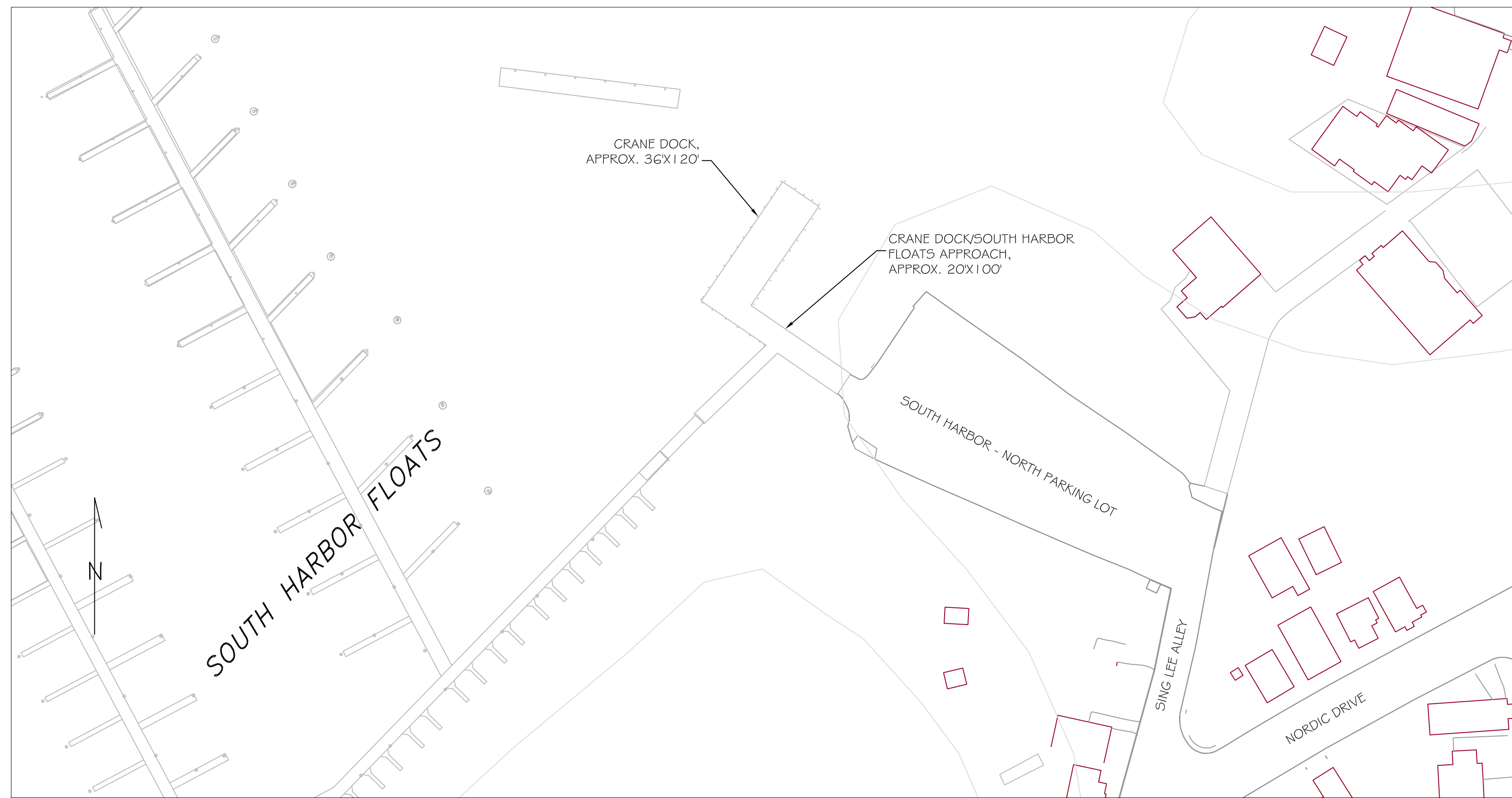

SOUTH HARBOR CRANE DOCK

City of Petersburg, Alaska

Drawn by SJC City of Petersburg Dept. of Community Development January, 2011



Mix of Pedestrian/Vehicle Access to Crane Dock & South Harbor



View of Crane Dock



Vehicle Access on Crane Dock



View From South Harbor Pedestrian Ramp Onto Crane Dock Access