

Agency: Commerce, Community and Economic Development**Grants to Municipalities (AS 37.05.315)****Grant Recipient: Petersburg****Federal Tax ID: 92-6000142****Project Title:****Project Type: Remodel, Reconstruction and Upgrades**

Petersburg - Crane Dock Upgrade

State Funding Requested: \$800,000**House District: 2 / A**

One-Time Need

Brief Project Description:

Upgrade and widen the apron and approach to existing commercial Crane Dock facility.

Funding Plan:

Total Project Cost: \$1,000,000

Funding Already Secured: (\$200,000)

FY2013 State Funding Request: (\$800,000)

Project Deficit: \$0

*Funding Details:**The City's share for this project will come from Harbor Fund Reserves.***Detailed Project Description and Justification:**

This project will upgrade and widen the apron and approach to Petersburg's existing commercial crane dock facility. Presently the 19-foot approach is the sole access point to both the crane dock facility and the north end pedestrian ramp of the South Harbor. These improvements will help alleviate much of the congestion and unsafe conditions of this high traffic area. This project will also increase efficiency for the large fishing fleet that uses the two cranes located on the dock. Fishing vessels and utility vehicles compete for the use of the facilities and there are often long waits. Trailers and vessels often block access to one of the cranes as commercial gear and provisions are loaded on and off.

Funding for this project will support retention of a consultant engineer to prepare bid-ready plans and design; permitting; survey and geotechnical investigation; preparation for and construction of dock apron and abutment; construction and installation of additional pilings and dock structure; and facility power and lighting systems.

Project Timeline:

Design: fall 2012

Construction: 2013

Entity Responsible for the Ongoing Operation and Maintenance of this Project:

City of Petersburg

Grant Recipient Contact Information:

Name:	Stephen Giesbrecht
Title:	City Manager
Address:	12 South Nordic Dr., PO Box 329 Petersburg, Alaska 99833
Phone Number:	(907)772-4425
Email:	steveg@ci.petersburg.ak.us

Has this project been through a public review process at the local level and is it a community priority? Yes No

<i>For use by Co-chair Staff Only:</i>
3:18 PM 5/2/2012

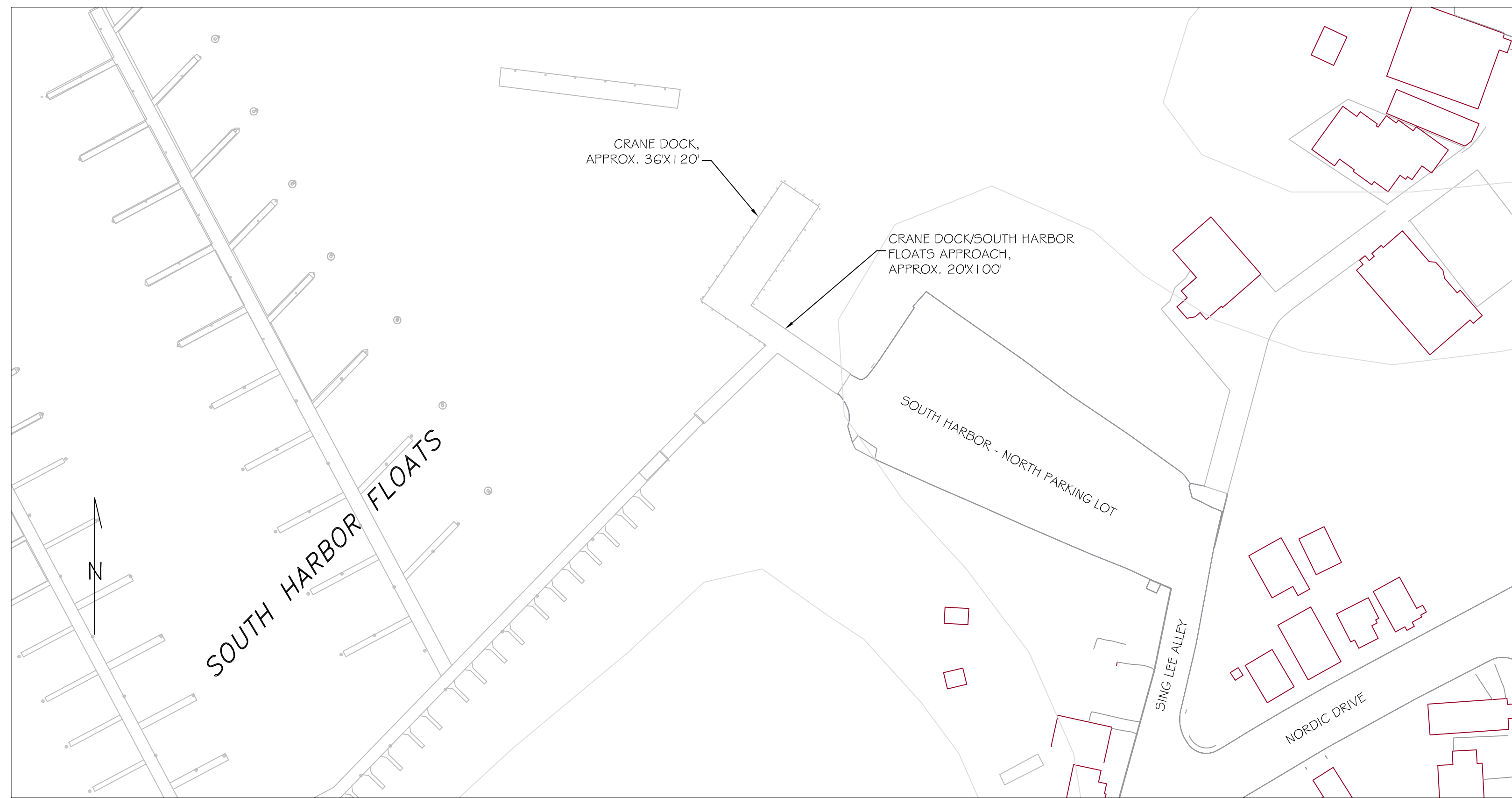

SOUTH HARBOR CRANE DOCK

City of Petersburg, Alaska

Drawn by SJC City of Petersburg Dept. of Community Development January, 2011



Mix of Pedestrian/Vehicle Access to Crane Dock & South Harbor



View of Crane Dock



Vehicle Access on Crane Dock



View From South Harbor Pedestrian Ramp Onto Crane Dock Access